



# Sympodium™ ID250

## Interactive Pen Display



### Make your message more memorable

The Sympodium ID250 interactive pen display makes any lecture more dynamic and keeps even large classes engaged and on topic. By connecting the ID250 to your computer and a projector, you can display your desktop on a screen for groups large and small. You have immediate access to all of your computer-based material, with the added dimension of interactivity.

Touching the pen tool to the ID250's LCD screen lets you launch and control applications, open files and write with digital ink over material including PowerPoint® slides, websites and moving video. Everything you do appears simultaneously on the projection screen. You can save your notes for future lectures or post them online for student review.

### Increase your flexibility

The ID250 interactive pen display sets the highest standard for smart classrooms. Designed for a range of presentation environments, the ID250 can be placed on a desk or lectern, or installed permanently.

The tethered pen used to interact with the display does not require batteries, and the easily accessible pen-tool buttons on the front of the unit eliminate the need for floating toolbars on your screen. At the heart of the ID250 is the same award-winning software that drives a SMART Board™ interactive whiteboard.

Whether it's in a lecture hall or classroom, the Sympodium ID250 lets you interact comfortably with your material while maintaining eye contact with the room. As a result, your students are more engaged and your message more memorable.

*"I can write the same thing on the blackboard and it's blasé. I write it on the Sympodium interactive lectern screen, and the students pay more attention. When they're more engaged and having more fun, they're going to learn more."*

*Joe Moore, Head of the Science Department  
Montrose High School, Montrose, Pennsylvania, U.S.*



Control computer applications and write notes on the LCD screen while your students see the same image projected on a larger screen.

# Features



## Pen-Tool Buttons

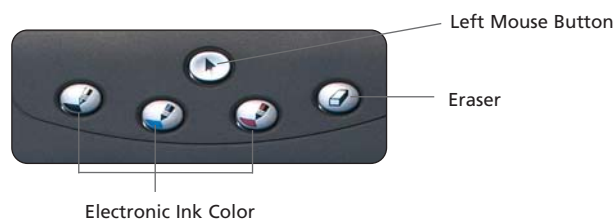

## Function Buttons

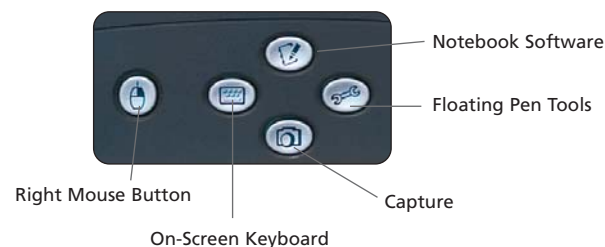

**Interactive screen** – Use the pen tool to control your computer and write notes over any application. The screen registers only the pen tool contact, so a touch by your palm or sleeve will not affect your work.

**Save function** – Capture your work in Notebook™ software or save notes directly into several software applications, including Windows® versions of Microsoft® PowerPoint, Word and Excel, or into AutoCAD® software.

**Battery-free tethered pen** – Write smoothly and comfortably with the securely attached pen.

**Pen-tool buttons** – Change ink color or use the eraser without crowding your display with toolbars.

**Function buttons** – Quickly access the right mouse button, on-screen keyboard, screen capture tool, floating tools and Notebook software.

**On-screen display buttons** – Fine-tune display properties to suit your preferences.

### SMART Board Software

#### Notebook software

Create, organize and save notes, drawings or screen captures, and access thousands of free images and templates.

#### SMART Board tools

Type with the On-Screen Keyboard, write over digital video, record a presentation, and much more.

#### LinQ software

Control your laptop or Tablet PC from the ID250. LinQ software uses your wired or wireless network to create a quick connection between devices.

**Adjustable tilt stand** – Move the console to a comfortable viewing angle.

**VESA mounting plate** – Integrate the ID250 with a variety of installations. Any VESA-75 LCD mounting arm can be used.

**RGB video pass-through** – Connect the ID250 to a digital projector so both devices display the same image.

**USB connection** – Connect the ID250 to a USB port.

**Warranty** – Two-year limited warranty.

## Dimensions

<b>Screen Area</b>	15" (38.1 cm) diagonal
<b>Size</b>	15 3/4" W x 2" H x 13 3/8" D (40.0 cm x 5.1 cm x 34.0 cm)
<b>Weight</b>	9 lb. (4.1 kg)

### System Requirements for Windows Operating Systems

Pentium® 150 MHz processor (450 MHz or faster recommended) • 128 MB of RAM (256 MB recommended)  
 • Available powered USB port • Approximately 160 MB of free hard disk space for a full installation • Windows NT® 4.0 (SP6), Windows 98 operating system or later • Microsoft Internet Explorer 5.0 or later • Macromedia® Flash® player version 7.0.19 or later (recommended)

### System Requirements for Macintosh® Computers

400 MHz processor (800 MHz or faster recommended) • 128 MB of RAM (256 MB recommended) • Available powered USB port • 50 MB of free hard disk space for minimum installation, 115 MB for full installation with Gallery collections • Mac OS® X version 10.1.5 or later (Java version 1.3.1 Update 1)

*Other versions of SMART Board software are available for UNIX® and Linux® systems, as well as for earlier Windows and Macintosh operating systems.*

Visit [www.smarttech.com/sympodium](http://www.smarttech.com/sympodium)



**SMART Technologies Inc.**  
 1207 – 11 Avenue SW, Suite 300  
 Calgary, AB T3C 0M5  
 CANADA  
 Phone +1.403.245.0333  
 Toll Free 1.888.42.SMART (Canada/U.S.)  
 Fax +1.403.228.2500  
 info@smarttech.com www.smarttech.com

Authorized SMART reseller